



# Triade Slim

WOOD  
AND  
GLASS  
SHELVING  
SYSTEMS





# SYMBOLS AND FINISHES LEGEND

## SYMBOLS

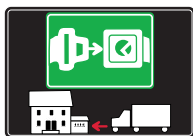

= SHELF SAFELY LOCKED DURING TRANSPORTATION AND AT HOME.



= ANTI-TURNOVER LOCKING SYSTEM



= NORMS / PATENTS



= PHILLIPS / POZIDRIV



= WITH BUFFER



= PART NO.



= BLADE SLOT



= WITH MAGNET



= PCS. PER PACKAGE



= COMBI SLOT



= HEXAGONAL SOCKET



= NEWTON



= CAPACITY LOADING



= HEXALOBULAR SOCKET



= FRICTION



= WOOD / GLASS THICKNESS



= COUNTERSUNK HEAD



= AUTOMATIC



= HOLE DIAMETER



= PAN HEAD



= DROP DOWN



= DIAMETER



= FLANGE HEAD



= LENGTH



= FLAT HEAD



= STANDARD HINGE



= HEIGHT



= TRILOBULAR SCREW



= KIMANA HINGE



= RIGHT VERSION



= SELF-TAPPING SCREW



= FLAP HINGE



= LEFT VERSION



= EURO THREAD



= WITH SPRING



= SETTING CODE



= METRIC THREAD



= WITHOUT SPRING



= PCS. PER PAD



= PRE-INSERTED SCREW



= REVERSED SPRING



= CUT ON REQUEST



= PRE-INSERTED SCREW AND SPREADING BUSH



= SELF ADHESIVE



= WITH FLANGE

NOTE: Printing errors and omissions may exist despite our best efforts to ensure accuracy. We reserve the right to alter specifications without notice.

## MATERIALS

<b>ZA</b> = Zinc Alloy	<b>ST</b> = Steel	<b>HSS</b> = High Speed Steel	<b>BR</b> = Brass	<b>ABS</b> = Acrylonitrile Butadiene Styrene
<b>ZAnk</b> = Nickel-plated Zinc Alloy	<b>STzk</b> = Zinc-plated Steel	<b>AL</b> = Aluminium	<b>WD</b> = Wood	<b>EVA</b> = Ethylene Vinyl Acetate

<b>EP</b> = <b>ENGINEERING PLASTIC</b>	+ <b>EP</b> = other engineering plastic available on request	<b>SR</b> = <b>SOFT RUBBER</b>	+ <b>SR</b> = other soft rubber available on request
--	--	--------------------------------	--

<b>EPn</b> = Natural Engineering Plastic	<b>EPc</b> = Clear Engineering Plastic	<b>SRn</b> = Natural Soft Rubber
<b>EPw</b> = White Engineering Plastic	<b>EPg</b> = Grey Engineering Plastic	<b>SRw</b> = White Soft Rubber
<b>EPwg</b> = Water Green Engineering Plastic	<b>EPa</b> = Anthracite Engineering Plastic	<b>SRb</b> = Black Soft Rubber

	<b>FINISHES</b>	+ 	= OTHER FINISHES AVAILABLE ON REQUEST
--	-----------------	---	---------------------------------------

PART NO.	FINISHES	PART NO.	FINISHES	PART NO.	FINISHES
<b>OO</b>	Insignificant finish	<b>IF</b>	Middle Grey	<b>RO</b>	Red
<b>AA</b>	Natural	<b>IJ</b>	Light Grey	<b>UT</b>	T-Met 9007
<b>AB</b>	White	<b>IL</b>	Grey 20	<b>UZ</b>	T-Met
<b>AE</b>	White 9010	<b>IN</b>	Grey met. 26	<b>WA</b>	Bronzed
<b>EA</b>	Black	<b>JB</b>	Bright Aluminium	<b>WI</b>	Burnished
<b>EC</b>	Matt Black	<b>JC</b>	Aluminium - Chrome	<b>XD</b>	Satin-finished Steel
<b>EE</b>	Anthracite	<b>JD</b>	Matt Aluminium	<b>YA</b>	Nickel-plated
<b>EW</b>	Grey 9007	<b>JE</b>	Satin-finished Aluminium	<b>YB</b>	Bright Nickel-plated
<b>FU</b>	Gunmetal	<b>JF</b>	Aluminium - Brass	<b>YC</b>	Matt Nickel-plated
<b>FV</b>	Gunmetal V52	<b>JG</b>	Aluminium 5	<b>YD</b>	Satin-finished Nickel-plated
<b>GR</b>	Raw	<b>JL</b>	Aluminium PE 11	<b>YQ</b>	Black Nickel
<b>HA</b>	Brass-Plated	<b>JM</b>	Aluminium RAL 9006	<b>Z9</b>	Black Zinc
<b>HH</b>	Tropicalized	<b>KA</b>	Chrome	<b>ZA</b>	Zinc alloy
<b>HL</b>	Raw Brass	<b>KB</b>	Bright Chrome	<b>ZN</b>	Zinc-plated
<b>HX</b>	Graphite	<b>KC</b>	Matt Chrome	<b>ZQ</b>	Bright Gold
<b>IA</b>	Grey	<b>LD</b>	Brown 8019	<b>ZY</b>	Titanium
<b>IB</b>	Metallic Grey	<b>NN</b>	Metallic Beige	<b>ZZ</b>	Clear

## TRIADE SLIM



18 mm min.



15 kg per pair for shelf 200 mm deep



PAT. PENDING



### SPECIFICATION

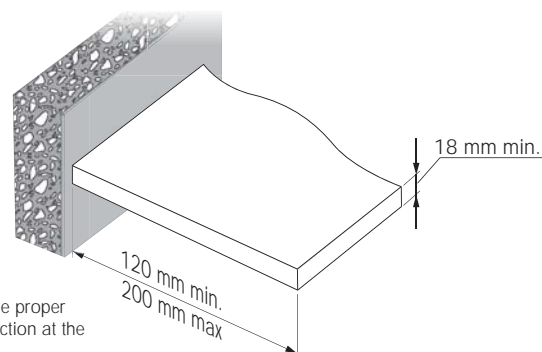
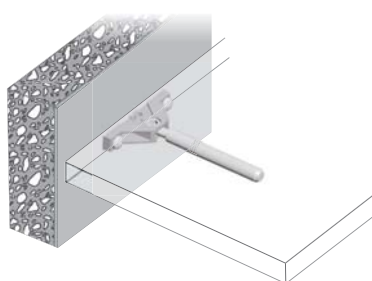
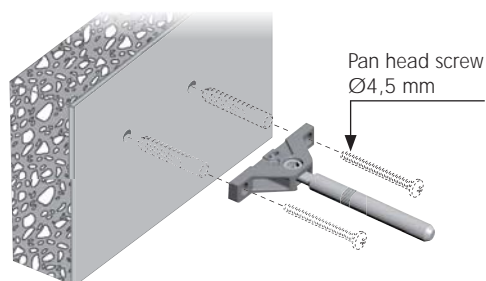

It is the responsibility of the customer: to ensure the wall is of a suitable quality to hold the shelf fixing in place and to use the proper hardware fittings according to the construction of the wall. For more specific information, please refer to the WARNINGS section at the end of the catalogue.

### ADJUSTMENT

#### BRACKET ALIGNMENT

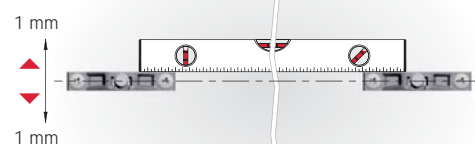
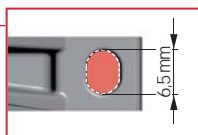

#### LATERAL ADJUSTMENT

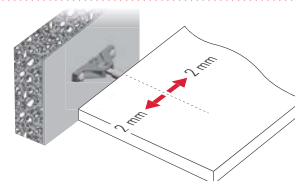

#### INCLINATION ADJUSTMENT

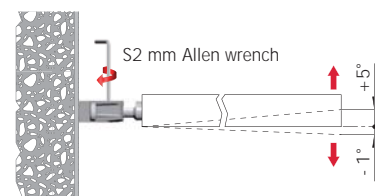

#### LOCKING:

**⚠ VERY IMPORTANT**  
Screw the ring to lock when adjustments are finished.

Unscrew the ring screw then act on the grub screw to change pin inclination.



### CAPACITY LOADING CHART

(The figures refer to 2 shelf supports)

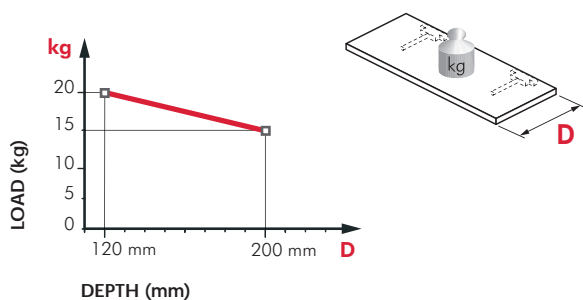

### RECOMMENDED NUMBER OF TRIADE SLIM PER SHELF

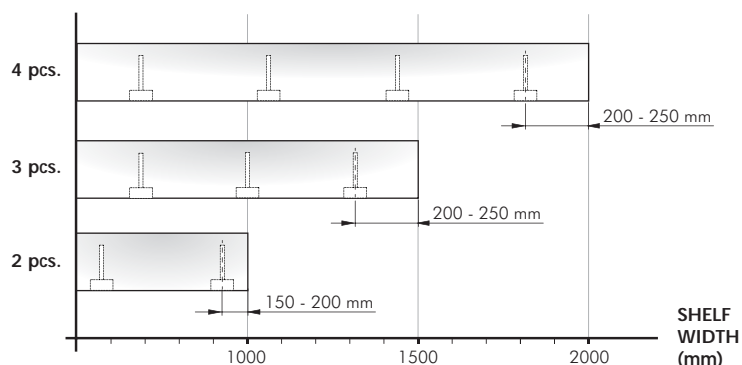

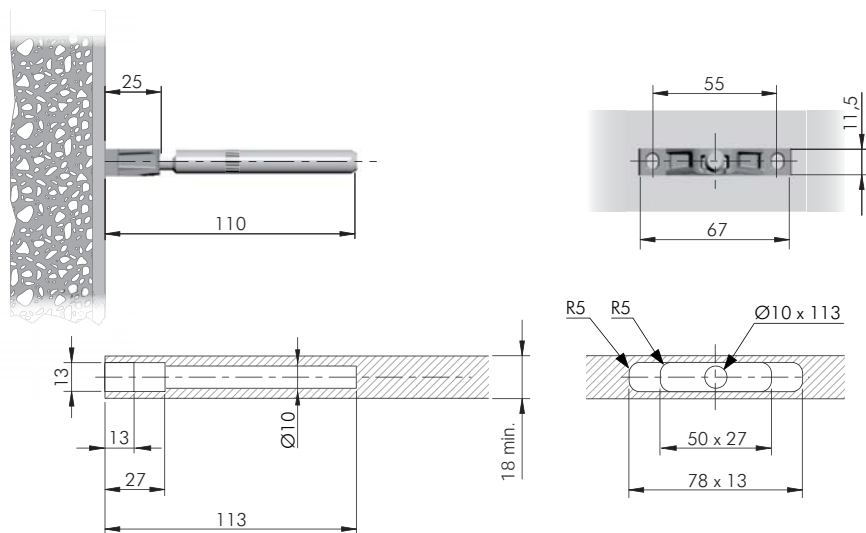

= open ended wrenches S2-S6

ZA ST EP

= 100 pcs.



1622501000

## OPTIONAL DRILLING FOR SECURITY LOCKING

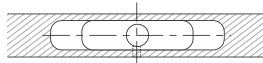
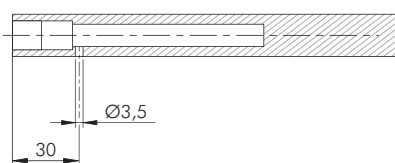
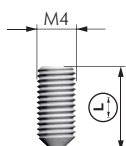

= S2 mm

ST

= 100 pcs.



21105210ZN



6



18-20 mm

21105180ZN

10

25 mm

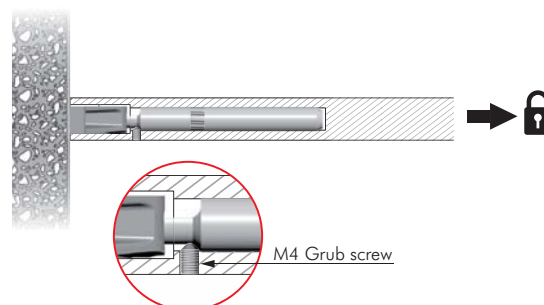
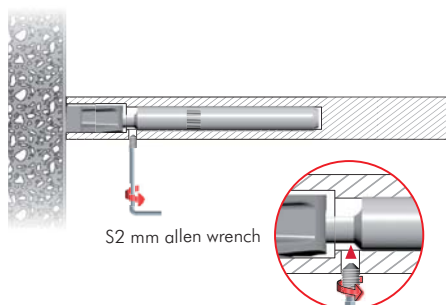

## TRIADE SLIM AND BRACKET



OPTIONAL SECURITY LOCKING

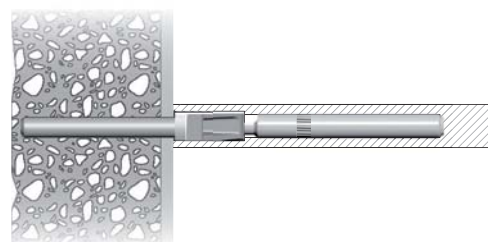
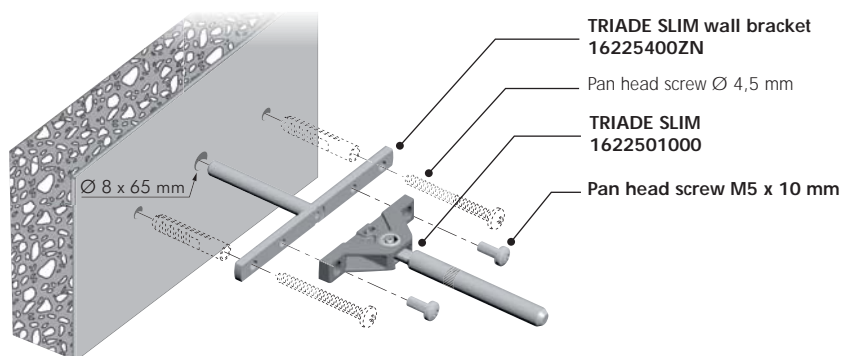

The wall bracket guarantees a more stable fixing to the wall.

It is the responsibility of the customer: to ensure the wall is of a suitable quality to hold the shelf fixing in place and to use the proper hardware fittings according to the construction of the wall. For more specific information, please refer to the WARNINGS section at the end of the catalogue.

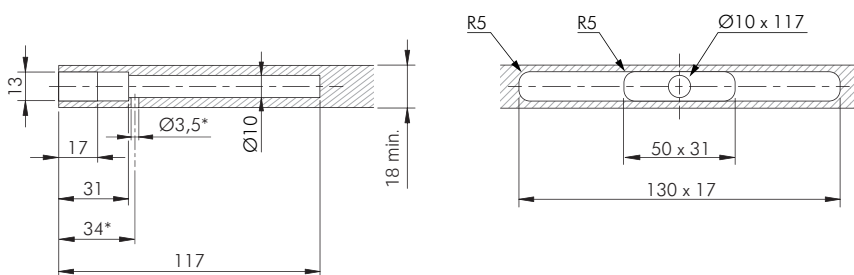

\* Optional drilling for security locking with M4 grub screw placed underneath in alignment with the cavity. For details refer to Triade Slim section.

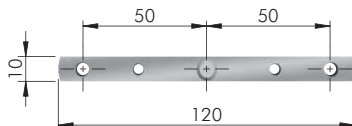
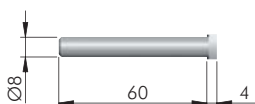

## FIXING ACCESSORY

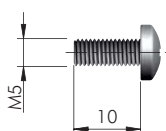

ST

= 100 pcs.



16225400ZN

= M5

= PZ2

ST

=







60334140ZN

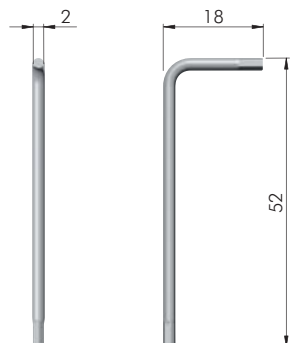





## TRIADE SLIM ACCESSORIES

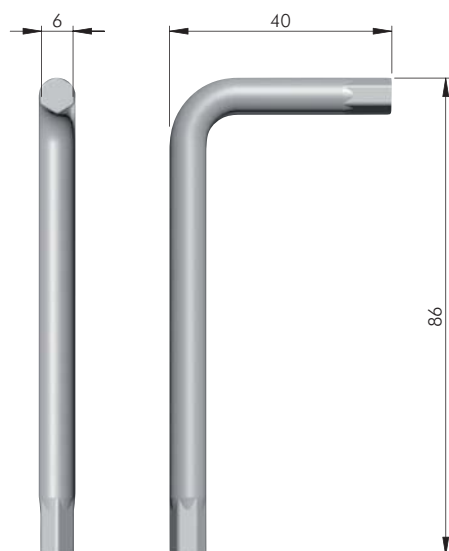

 = S2	 = 1000 pcs.
	
  <b>62501090ZN</b>	



 = S6	 = 500 pcs.
	
  <b>62501040ZN</b>	

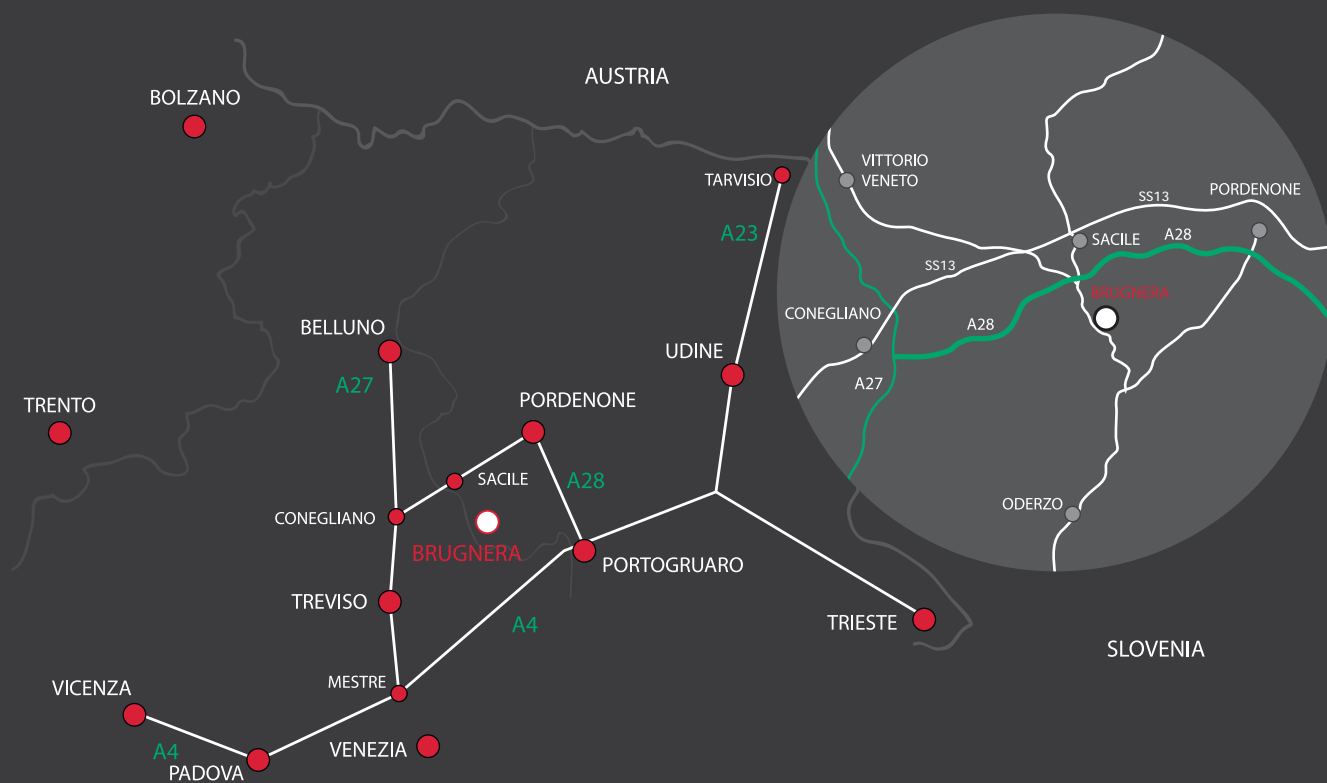

[www.italianaferramenta.it](http://www.italianaferramenta.it)